

FENCING LEGEND:



5m High Irren Kinsale 868 Combo Standard Sports Mesh Fence System. Fence Comprising of 3m High Kinsale 868 Mesh Panels with 2m High Irren Ballstop Netting Over.



2.4 High Sports Mesh Fence System Consisting Of Kinsale 868 Mesh Panels.

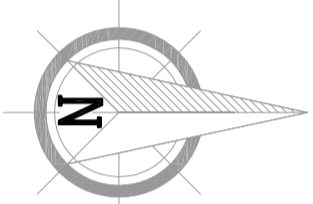

PASTURE LAND

EXISTING PITCH No.01 GL: 49.00

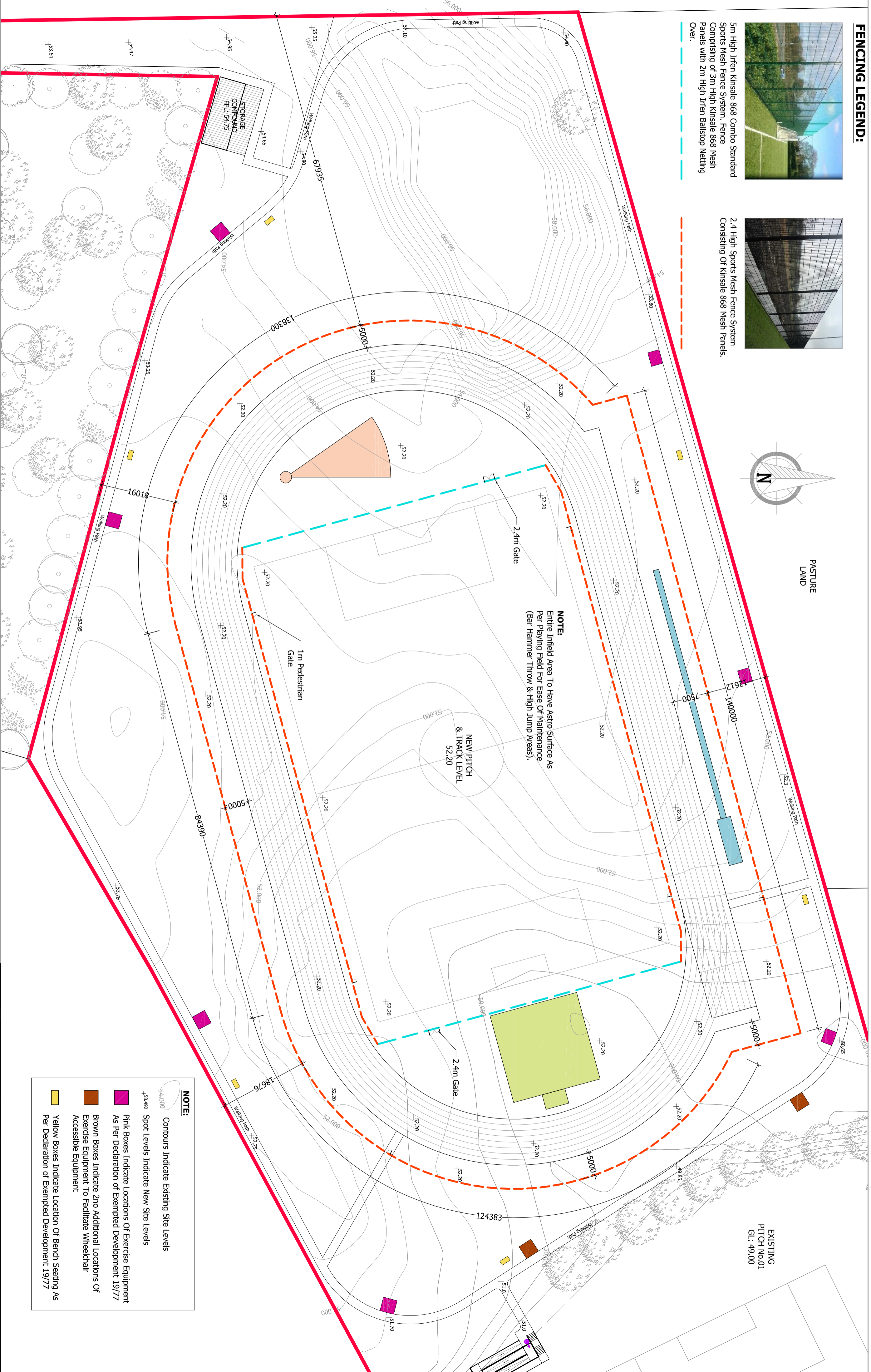

NOTE:
Entire Infield Area To Have Astro Surface As Per Playing Field For Ease Of Maintenance (Bar Hammer Throw & High Jump Areas).

- NOTE:**
- Contours Indicate Existing Site Levels
 - Spot Levels Indicate New Site Levels
 - Pink Boxes Indicate Locations Of Exercise Equipment As Per Declaration of Exempted Development 19/77
 - Brown Boxes Indicate 2no Additional Locations Of Exercise Equipment To Facilitate Wheelchair Accessible Equipment
 - Yellow Boxes Indicate Location Of Bench Seating As Per Declaration of Exempted Development 19/77

SPORTS FIELD LEGEND:

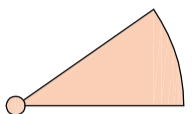

21m Hammer Throw Field In Compacted Gravel With 2.5mø Concrete Throw Base

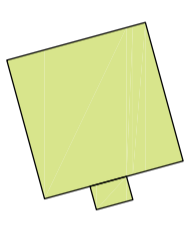

19 x 19m² High Jump Run Up Area In Tartan Finish As Per Track. Remainder Of Infield In 4G Finish As Per Pitch.

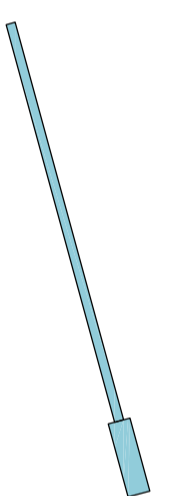

Long Jump / Triple Jump Lane In Tartan Finish As Per Track With Sand Based Landing Area.



MOANBAUN SPORTS DEVELOPMENT	
Project:	MOANBAUN SPORTS DEVELOPMENT
Dwg. No.:	04-0420
Title:	SPORTS FIELD LAYOUT & SITE FENCING
Scale:	1:500 on A2
Client:	MOANBAUN SPORTS DEVELOPMENT COMPANY LTD.
Date:	31st AUGUST 2020
Drawn By:	KENNETH O'HARA

01 SPORTS FIELD LAYOUT
04 1:500